

OSNOVNA ŠKOLA KOSTRENA

PLAN EVAKUACIJE I SPAŠAVANJA

SUTEREN

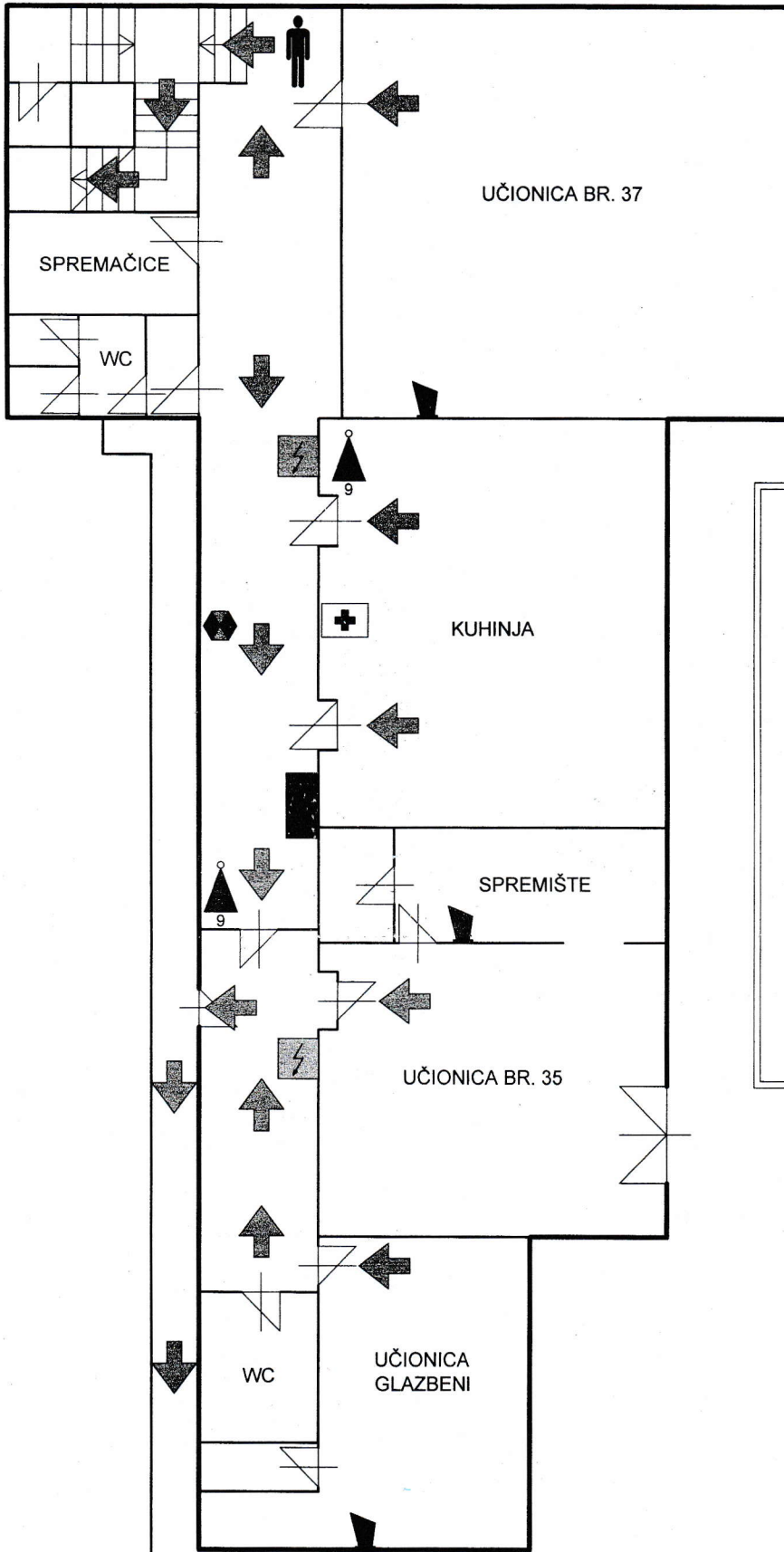

LEGENDA:

-  VI SE NALAZITE OVDJE
-  SMJER NORMALNE EVAKUACIJE IZ GRAĐEVINE
-  PROSTOR POKRIVEN RAZGLASOM
-  VATROGASNI APARAT
9
-  RAZVODNI ORMAR
-  UNUTARNJI HIDRANT S OPREMOM POD TLAKOM
-  PROSTOR POKRIVEN PANIK RASVJETOM
-  ORMARIĆ PRVE POMOĆI

IZRADIO:

 INDEL-ZAŠTITA d.o.o. RIJEKA
J. Trdine 7/II; tel/fax 051-212-689; fax 051-317-575
Prosinac 2010.







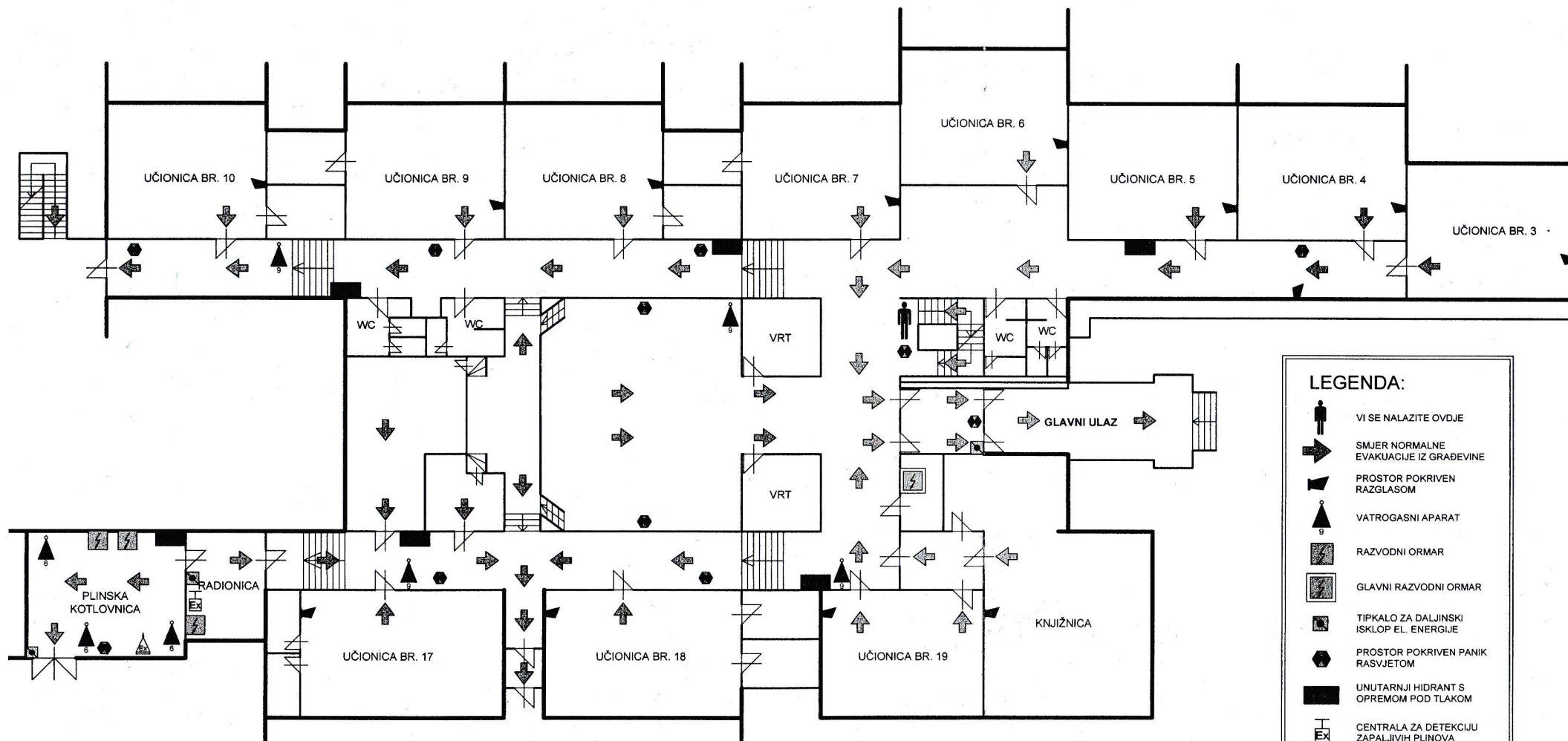

OSNOVNA ŠKOLA KOSTRENA

PLAN EVAKUACIJE I SPAŠAVANJA

PRIZEMLJE



LEGENDA:

-  VI SE NALAZITE OVDJE
-  SMJER NORMALNE EVAKUACIJE IZ GRADEVINE
-  PROSTOR POKRIVEN RAZGLASOM
-  VATROGASNI APARAT
-  RAZVODNI ORMAR
-  GLAVNI RAZVODNI ORMAR
-  TIPKALO ZA DALJINSKI ISKLOP EL. ENERGIJE
-  PROSTOR POKRIVEN PANIK RASVJETOM
-  UNUTARNJI HIDRANT S OPREMOM POD TLAKOM
-  CENTRALA ZA DETEKCIJU ZAPALJIVIH PLINOVA
-  PROSTOR POKRIVEN SUŠTAVOM ZA DETEKCIJU ZAPALJIVIH PLINOVA

IZRADIO:
 INDEL-ZASTITA d.o.o. RIJEKA
 J. Trdine 7/II; tel/fax 051-212-689; fax 051-317-575
 Prosinac 2010.

OSNOVNA SKOLA KOSTRENA

PLAN EVAKUACIJE I SPAŠAVANJA

KAT

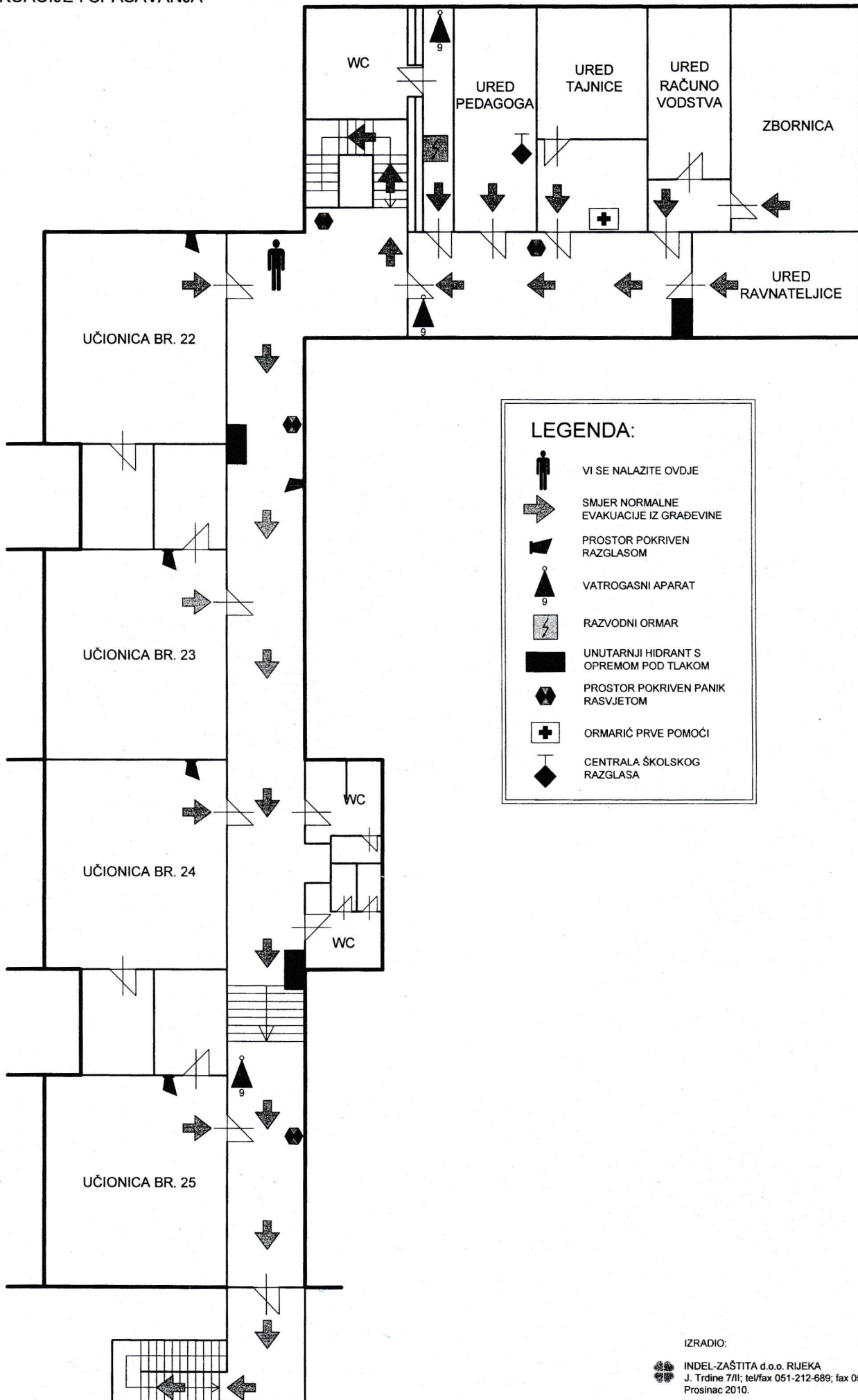

LEGENDA:

-  VI SE NALAZITE OVDJE
-  SMJER NORMALNE EVAKUACIJE IZ GRAĐEVINE
-  PROSTOR POKRIVEN RAZGLASOM
-  VATROGASNI APARAT
-  RAZVODNI ORMAR
-  UNUTARNJI HIDRANT S OPREMOM POD TLAKOM
-  PROSTOR POKRIVEN PANIK RASVJETOM
-  ORMARIĆ PRVE POMOĆI
-  CENTRALA ŠKOLSKOG RAZGLASA

IZRADIO:



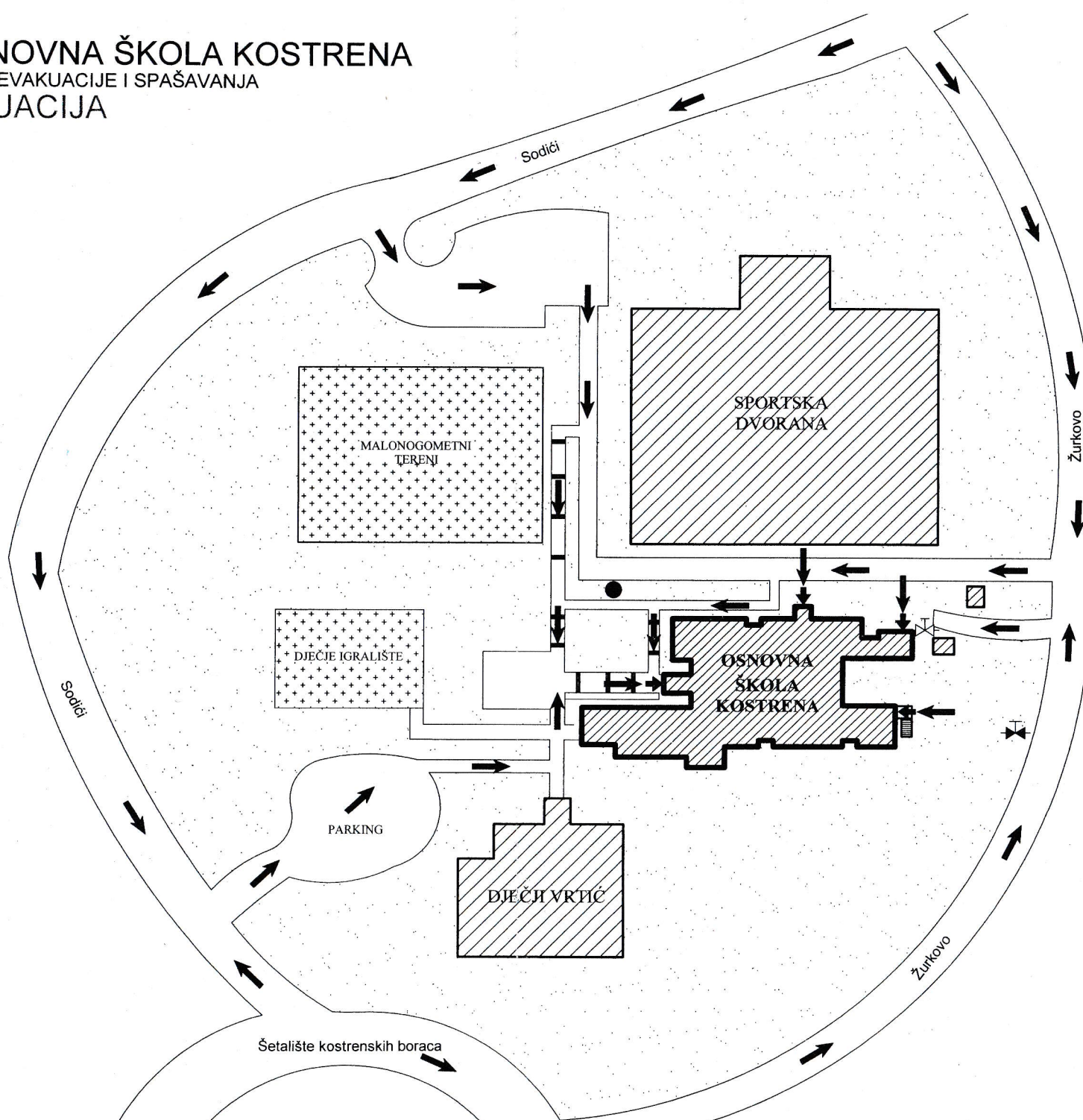

 INDEL-ZAŠTITA d.o.o. RIJEKA
 J. Trđine 7/II; tel/fax 051-212-689; fax 051-317-575
 Prosinac 2010.

OSNOVNA ŠKOLA KOSTRENA

PLAN EVAKUACIJE I SPAŠAVANJA
SITUACIJA



LEGENDA:

-  SMJER VATROGASNE INTERVENCIJE
-  ULAZ U OBJEKT
-  GLAVNI ZAPORNI VENTIL PLINA
-  GLAVNI ZAPORNI VENTIL VODE
-  VANJSKI HIDRANT NADZEMNI

IZRADIO:

 INDEL-ZASTITA d.o.o. RIJEKA
J. Trdine 7/II; tel/fax 051-212-689; fax 051-317-575
Prosinac 2010.